



SUPERNOVA Heated Gloves & Mitts with ALPHAHEAT™ and ACTIVEDRY™

INSTRUCTIONS FOR USE

For your safety and the safety of those around you, please read these use guidelines carefully before using your gloves or mitts. Failure to adhere to these guidelines can result in serious injury and loss of property.

HOW TO USE THE CONNECTOR COVER

WARNING: If your gloves/mitts are operated with the connectors exposed, it is possible for the electronics to endure significant stresses if the connection is pushed or pulled. The connector cover protects the connection; eliminating the potential for these stresses to occur and ensuring that the performance of your gloves/mitts is not accidentally compromised. To learn how to use the cover, follow the sequence of illustrations in Figure 1 to 5.

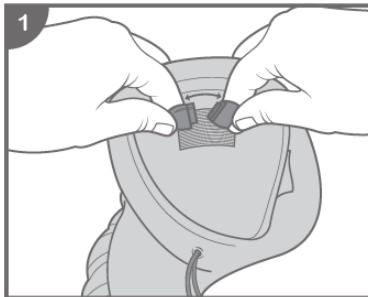

Figure 1: Hold the glove/mitt, gripping each connector as shown

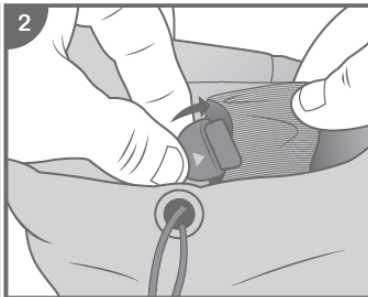

Figure 2: Grab and pull the right side of the cover to open the left side of the cover

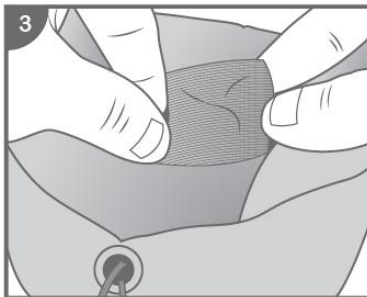

Figure 3: Insert the left connector into the cover

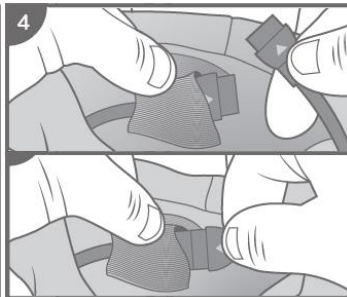

Figure 4: Pull the left side of the cover to open the right side, exposing the connector head; make the connection

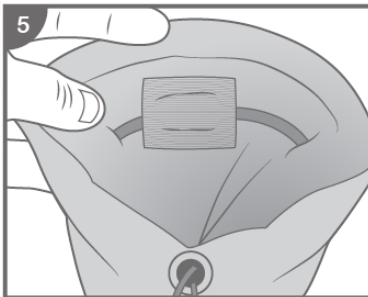

Figure 5: Connection completed

HOW TO USE LATCHING CONNECTORS

WARNING: You will be unable to disconnect the connectors before understanding how to operate them. Please carefully read these instructions. Trying to force the connectors apart without properly unlatching can result in irreparable damage.

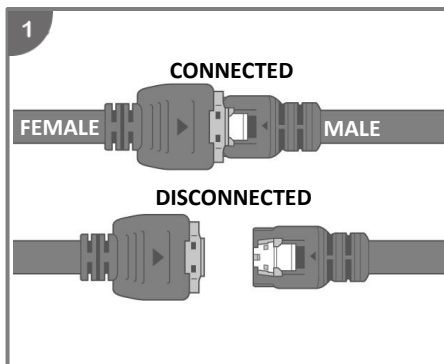

Figure 1: These are latching connectors located in the cuff of your gloves/mitts and on the charger leads.

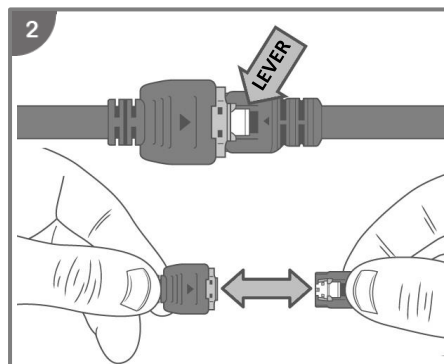

Figure 2: To unlatch, press the tab/lever on the male end with your thumb while pulling them directly apart. Warning: Flexing or “wiggling” the connectors to get them apart will damage them in time. To maintain the health of the connectors, pull them directly apart without flexing them.

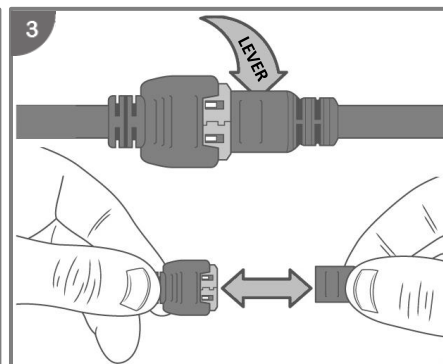

Figure 3: Inside the cuff of the right hand, the tab/lever is on the backside of the connector assembly. Press it using your index finger. Then pull them directly apart.

For your safety and the safety of those around you, please read these use guidelines carefully before using your gloves or mitts. Failure to adhere to these guidelines can result in serious injury and loss of property.

CHARGING WITH ACTIVE DRY™ CHARGER

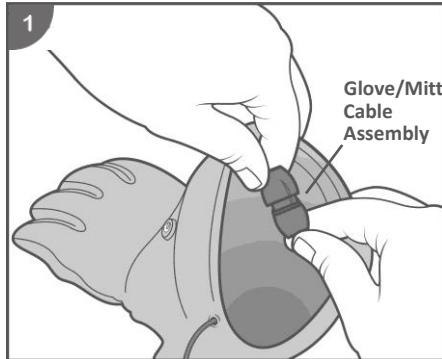

Figure 1: The cable assembly that contains the charging plug is located just inside the interior cuff

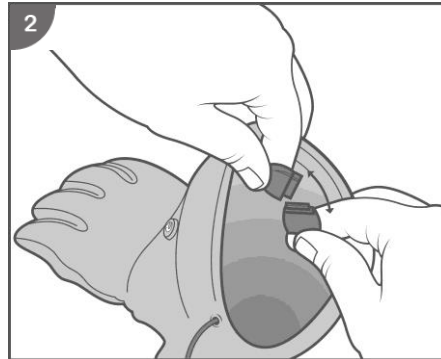

Figure 2: Hold only the plug heads when disconnecting the charging plug from the cable assembly

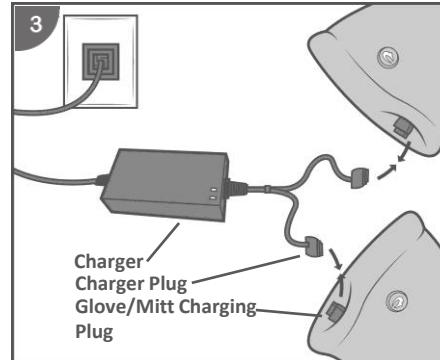

Figure 3: Connect each glove/mitt charging plug to a charger plug to automatically start the charging process

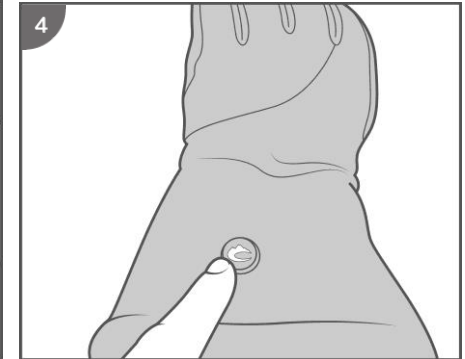

Figure 4: Press the control button for 3 seconds to activate; repeat to deactivate

Fully charge your gloves/mitts before first use. Most pairs are fully charged before shipment.

1. The cable assembly that contains the glove/mitt charging plug is located just inside the interior cuff (Figure 1). You must first disconnect the glove/mitt cable assembly. When disconnecting the charging plug from the glove/mitt cable assembly (Figure 2), hold only the plug heads, not the cables.

IMPORTANT: These are latching connectors, so the tab/lever on the smaller male connector must be pressed to enable the connectors to be separated (see *HOW TO USE LATCHING CONNECTORS*).

2. Plug the ACTIVE DRY™ charger (Figure 3) into an electrical outlet. The charge indicator lights on the charger will illuminate green.

3. Connect the glove/mitt charging plugs to the two charger plugs (Figure 3). The charging process will automatically start and the charge indicator lights will turn red (unless already fully charged). At the same time, the ALPHAHEAT™ system in each glove/mitt will activate to accelerate the drying process.

4. To maximize the effectiveness of the drying process:

Open the gauntlet cuff and elevate the cuff above the fingers to allow the warm wet air from inside of the glove/mitt to escape. If this is not done, moisture will be trapped in the fingertips.

Do not set anything on top of the gloves/mitts while charging.

Do not set the gloves/mitts on top of each other while charging.

About 8 hours are required to fully recharge discharged gloves/mitts.

When the gloves/mitts are 90-95% charged, the charge indicator lights will turn green and the ALPHAHEAT™ heating system will deactivate, but the gloves/mitts will continue to trickle-charge up to a full charge.

Do not allow the gloves/mitts to remain connected to a powered charger more than 24 hours.

5. Disconnect both glove/mitt charging plugs from the charger plugs. **IMPORTANT:** These are latching connectors, so the tab/lever on the smaller male connector must be pressed to enable the connectors to be separated.

6. Line up the plugs in each glove/mitt's cable assembly and reconnect them (Figure 1).

Recharge gloves/mitts after each use to protect the battery system and ensure they are ready for use. Store and transport them with the glove/mitt cable assembly plugs disconnected to ensure they are not activated and the batteries not unintentionally drained.

The proprietary lithium polymer battery system in these gloves/mitts does not need to be fully discharged before recharging.

WARNING: Do not place the charger in a confined space. Ensure that the charger is well ventilated. The charger must dissipate a large amount of heat and will become hot during the charging process. Do not try to open the gloves or mitts to gain access to the battery system. It is a closed, proprietary system with no replaceable parts. Do not expose the gloves or mitts to an open flame. Improper handling of lithium polymer batteries can cause them to explode!

USE

The single control button (Figure 4) is used to turn the heating system on and off. The center of the button will illuminate to indicate the system is active and heating.

Activate: Press the button and hold for 3 seconds to turn on the heating system. The button will illuminate.

Regulation: The automated heat regulation adjusts with ambient conditions, your hand temperature and other environmental factors.

Deactivate: Press the button and hold for 3 seconds to turn off the heating system. The illuminated button will de-illuminate.

WARNING: Use the heating system only in cold conditions. If used indoors or in warm conditions, the heat could become excessive. Avoid overheating your hands. If your hands are becoming sweaty or overheated, turn the system off until needed again.



SUPERNOVA Heated Gloves & Mitts

with ALPHAHEAT™ and ACTIVEDRY™

INSTRUCTIONS FOR USE

For your safety and the safety of those around you, please read these use guidelines carefully before using your gloves or mitts. Failure to adhere to these guidelines can result in serious injury and loss of property.

SAFETY PRECAUTIONS

If you have difficulty sensing hot or cold objects (e.g. diabetics, disabled persons, Raynaud's, etc.), please consult your doctor before using these gloves or mitts.

Not for use by children.

Use only the supplied charger to charge the gloves or mitts.

Check your fingers regularly for reddening of the skin. Excessive heating over prolonged periods can lead to burns.

The drying temperature must not exceed 60 °C (140 °F). Do not dry gloves or mitts on a heater or in clothes dryers.

Do not wear the gloves or mitts during the charging process.

Do not insert any foreign object into connecting sockets or plugs as this could damage the heating system.

Stop using the unit if you discover any damage to the connecting cables, battery system or other parts. If you are unsure if your glove or mitt is safe for use, contact Chaval Outdoor for clarification. Do not crush, twist, impact or pierce a glove or mitt with sharp objects. If this occurs, discontinue use of the glove or mitt immediately.

Do not make any modifications to the unit or use it for any unintended purposes. Repairs to the unit or its connecting plugs are only to be carried out by the manufacturer.

If you have any questions or concerns, please contact Chaval Outdoor.

CLEANING

Dirty gloves/mitts can be cleaned using a damp cloth. These gloves/mitts should never be washed in a washing machine or be immersed in water.

STORAGE AND CARE

The SuperNova contains a proprietary lithium polymer battery system and can be charged in any state. It is unnecessary to fully discharge the batteries before charging.

Do not leave the gloves/mitts connected to the charging system for more than 24 hours.

Store and transport them with the glove/mitt cable assembly plugs disconnected to ensure they are not activated and the batteries not unintentionally drained.

Do not store gloves/mitts fully discharged. If discharged, charge for about 3 hours before storage. Store them in a cool, dry room (from 5 °C [41 °F] to 20 °C [68 °F]).

In case of long-term storage, recharge the gloves/mitts every 6 months for about 3 hours. Proper storage maximizes battery performance and durability.

Do not crush, twist, incinerate, short circuit, dismantle or immerse in liquids.

DISPOSAL

Dispose of gloves/mitts and packaging in an environmentally-responsible way and in accordance with local regulations. Do not dispose of electrical equipment in unsorted municipal waste. Recycle all electronics at the appropriate collection or recycling center. By recycling, you help protect the environment and public health. Please contact your local authority for more information.

REPAIR

Repair of your gloves/mitts can be facilitated by contacting Chaval Outdoor: customerservice@ChavalUSA.com

TECHNICAL DATA

Charger Input: 100 – 240 V (50-60 Hz)

Charger Output: 2 x 4.2 V / 1 A

Proprietary Lithium-Polymer battery system: 3.7 V / 3900 mAh

MAX. TEMPERATURE* PER CHARGE

62 °C (144 °F) for 6 hours

* Measured on the heating element under laboratory conditions. The length of time the heating system will produce heat depends on weather conditions, user's physiology & system charging level.

WARNING: Chaval Outdoor Corporation is not responsible for the consequences, whether direct, indirect, or accidental, or for any other type of damage arising or resulting from the use of its products. You are responsible for your actions and activities and for any consequences that may result from them.